

IMPROVED **R A C I N G**

STRUT TOWER BAR WITH OPTIONAL MASTER CYLINDER BRACE FOR MAZDA RX-7 (FD3S)

**PART NOS. SMA-200, SMA-201,
SMA-202**

MADE IN USA

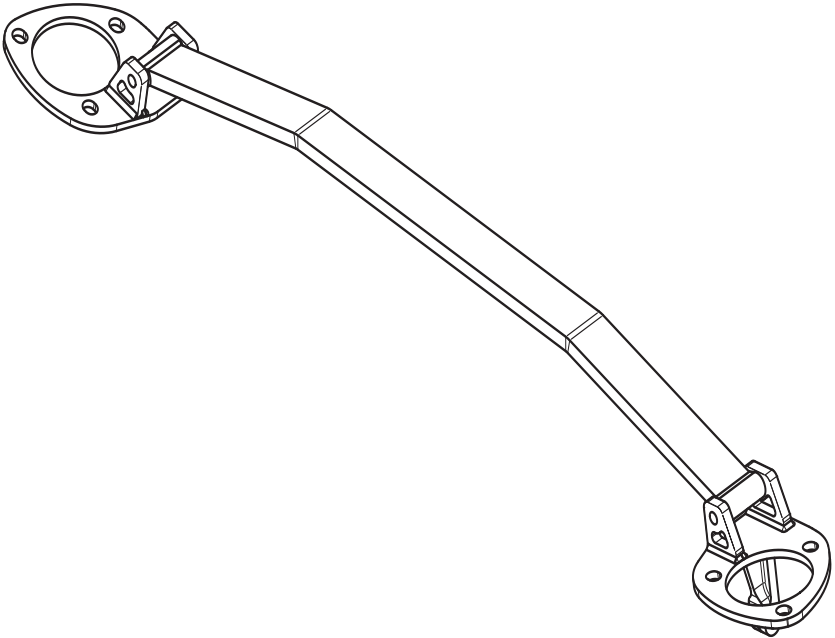

**Important: Read these instructions in their
entirety prior to installation.**

For contact information, visit www.improvedracing.com
Copyright © 2008-2020 Improved Racing Products, LLC. All rights reserved.

APPLICATIONS

- 1993-2002 Mazda RX-7 with 13B and 20B engines
- 1993-2002 Mazda RX-7 with Engine Swaps:
 - Toyota 1JZ / 2JZ swaps
 - GM LS-series engine swaps, except FAST 102mm or taller intakes

TOOL SPECS FOR THE HARDWARE

- The tool sizes for the hardware that connects the strut tower plates to the cross-bar are as follows:
 - **$\frac{3}{8}$ "-16, 3- $\frac{1}{2}$ " long screws:** $\frac{9}{16}$ inch socket or wrench
 - **$\frac{3}{8}$ "-16 flange nuts:** $\frac{9}{16}$ inch socket or wrench
- Hex key sizes for the brake master cylinder (MC) brace hardware are:
 - **$\frac{3}{8}$ "-16 MC Brace Screw w/Delrin Pad (Long & Short):** $\frac{3}{16}$ inch
 - **M6x1.00, 14mm long MC Clamp Screw:** 5 mm

INSTALLING THE STRUT TOWER BAR

1. Loosely assemble the strut tower plates to the cross-bar using the 3- $\frac{1}{2}$ inch long $\frac{3}{8}$ "-16 screws, washers and nuts.
2. Insert the Delrin pad onto the tip of the brace screw. Use the longer brace screw for the OEM Mazda Rx-7 brake master cylinder and the shorter screw for the Mazda 929 brake master cylinder.



Refer to Figure 1 to install the correct length screw for your brake master cylinder.

3. Apply a some anti-seize or a thread lubricant to the M6 clamp screw and insert it into the brace.
4. With the car resting on the ground, remove all six strut tower flange nuts.
5. Position the strut tower bar assembly onto the strut towers.
6. Align the strut bar so that the brace screw is centered on the brake master cylinder.
7. Torque the strut nuts to 34-46 lb-ft (47-62 N-m).
8. Use a $\frac{9}{16}$ inch tool to torque the hardware that secures the bar to the strut tower plates. Torque the hardware to 24-33 lb-ft (32-46 N-m).
9. Use a $\frac{3}{16}$ inch hex key to preload the Delrin pad of the brace screw against the MC.

10. Use a 5 mm hex key to tighten the M6 clamp screw down onto the MC brace screw. Torque to approximately 96 lb-in (10 N-m).

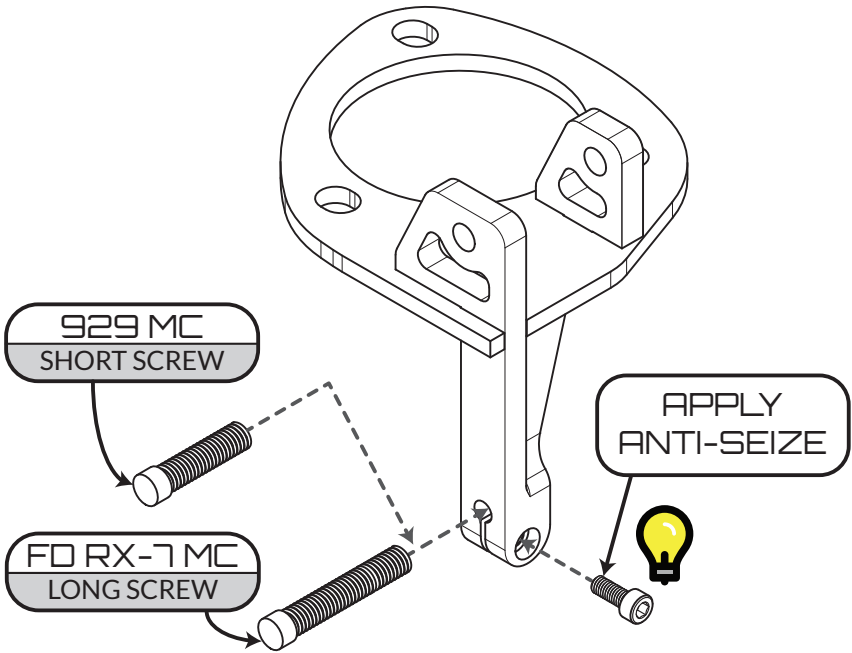

Figure 1 - Installing the Strut Tower Plate MC Brace Hardware

Installation is now complete. Thank you for purchasing an Improved Racing product!